

Memorandum of Easements in Gross

Purpose	Shown	Servient Tenement	Grantee
Right of Way	A	Lot 400 hereon	Auckland Council
Right of Way (Pedestrian only)	B		
Right of Way, Right to Transmit Electricity, Telecommunications and Computer Media, Right to Convey Water, Right to Drain Stormwater	Lots 100 & 102 hereon	Lots 100 & 102 hereon	Te Arai North Limited & Tara Iti Holdings New Zealand Limited
	A	Lot 400 hereon	Tara Iti Holdings New Zealand Limited



COPYRIGHT©

This drawing and parts thereof are copyright to Southern Land Ltd, and shall not be reused, copied or reproduced without the written permission of Southern Land Ltd.

Notes:

Warning

This Plan has been prepared for the purpose of a resource consent application only. It is not a precise survey plan. As areas and dimensions are likely to vary upon survey it should not be attached to sale & purchase agreements without an appropriate condition to cover such variations.

Any person using Southern Land drawings and other data accepts the risk of:
 - using the drawings and other data in electronic form without requesting and checking them for accuracy against the original hard copy versions or with Southern Land Ltd directly.
 - ensuring the information is the most recent issue.

CAD and Production by:



SOUTHERN LAND
 SURVEYING | PLANNING | LAND DEVELOPMENT
 21 Bowman St, Waiwaka,
 Ph: (03) 443 5577
 Email: contact@southernland.co.nz
 www.southernland.co.nz



A DIVISION OF THE NEW ZEALAND INSTITUTE OF SURVEYORS

APPLICANT
Te Arai North Limited

COMPILED BY
701932, 701936

TERRITORIAL AUTHORITY
AUCKLAND COUNCIL

LAND DISTRICT
NORTH AUCKLAND

TOTAL AREA
174.2755 ha DATE
29/09/15

Drawing Title:

**LOTS 12 - 20, 100, 102, 400 & 500
 BEING A PROPOSED
 SUBDIVISION OF LOTS 100 &
 400 DP 483489**

Prepared for:

Resource Consent Issue

Plan Revisions:

REV.	DESCRIPTION	DATE
A	ORIGINAL ISSUE	29/09/15
B	BP POSITIONS REVISED	16/10/15

R65973

SCALE
1:8,000 @ A3

DATUM & LEVEL
MT EDEN 2000

REVISION	DRAWING REFERENCE	SHEET
B	O4064_S10	1 OF 1
DATE SURVEYED	DATE DRAWN	CHECKED
X.X	XX/XX/XX	LW
DATE DRAWN	DATE APPROVED	DATE
LW	29/09/15	LW
		29/09/15

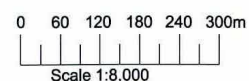
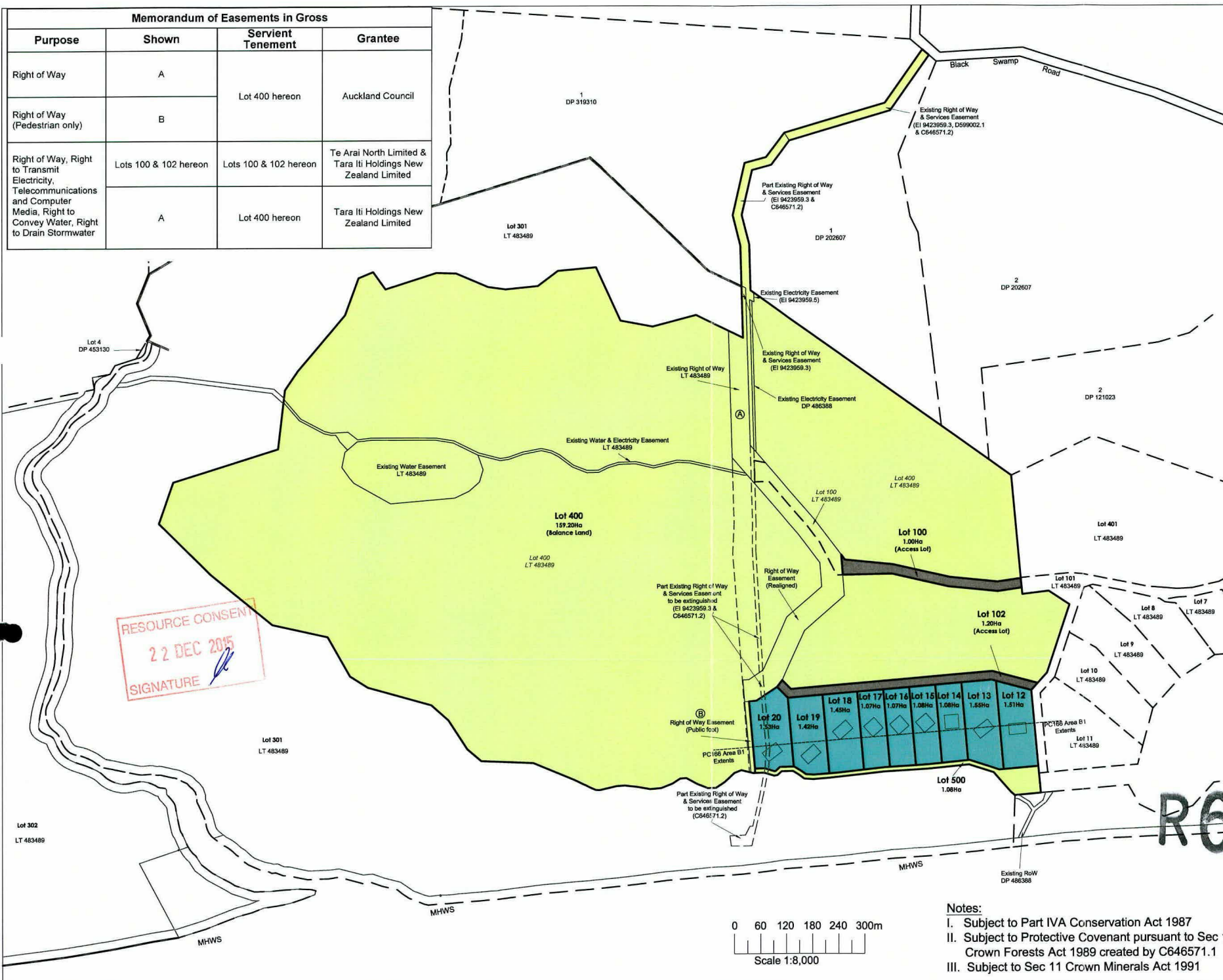

Notes:

- I. Subject to Part IVA Conservation Act 1987
- II. Subject to Protective Covenant pursuant to Sec 19 Crown Forests Act 1989 created by C646571.1
- III. Subject to Sec 11 Crown Minerals Act 1991